

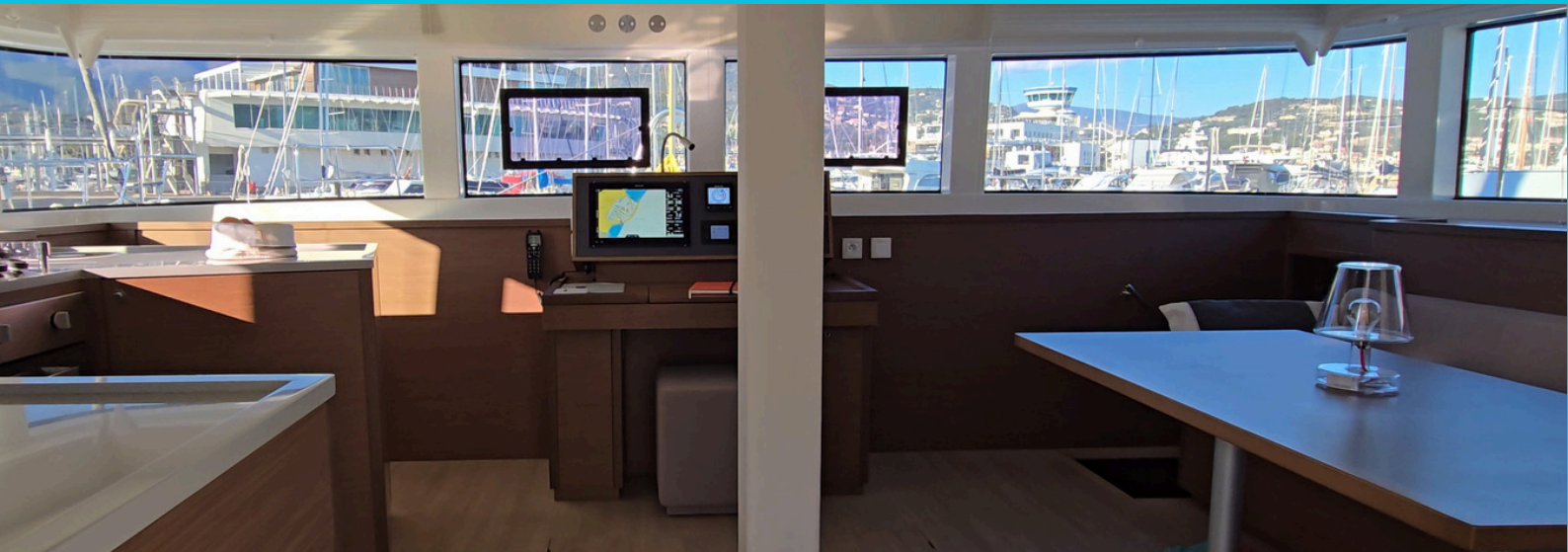

# COCOS

*Lagoon 52s*



CRUISING CATAMARAN

[www.nautilus-yacht.com](http://www.nautilus-yacht.com)  
+31 649863471



## INFORMATION

Price: €959,000 VAT paid  
Location: Genua, Italy  
Year: 2019  
LOA: 52' / 15.85m  
LWL: 50.1' / 15.50m  
Beam: 28,3' / 8.60m  
Draft: 4.11' / 1.50m  
Displacement: 22490kg/ 49606lb  
Hull: polyester  
Engines: 2 x Yanmar 4JH80 80 hp  
yard: Lagoon Bordeaux  
Architect: VPLP-Design  
Accommodations: 8 berths in 4 cabins



## DISCRIPTION

The Lagoon 52-S Cocos is a large cruising catamaran from the Lagoon range. The SporTop version with the helm split level provides a perfect overview and connection with other passengers.

### Bridge deck:

- On the bridge deck is a very spacious salon with a spacious sitting area and a large open kitchen equipped with all necessary equipment such as refrigerators, stove and oven. The characteristic windows of the Lagoon provide plenty of light and all-round visibility. In the middle of the windows is the navigation table with an extra navigation plotter. The sliding door connects the salon on the ground floor with the covered outdoor deck. This outdoor area has a spacious U-shaped sitting area with a beautiful teak table, a lounge sofa and a beautiful teak floor.

The Cocos has 4 cabins.





## DISCRIPTION

### Starboard hull:

- a very spacious owner's cabin with a queen size bed placed transversely so that you have a direct view of the sea through the window. The cabin is equipped with a spacious shower, sink, a desk/dressing table and a separate toilet.
- a luxury guest cabin with a queen size bed that is placed transversely so that you have a view of the sea. The cabin is equipped with a desk/dressing table and a private bathroom with an open shower, sink and toilet.
- -a washer/dryer combination and an extra refrigerator with freezer

### Port hull:

- a VIP guest cabin with its own access from the cockpit area with a queen size bed, desk/dressing table, spacious bathroom with shower, sink and toilet.
- a luxury guest cabin with a queen size bed that is placed transversely so that you have a view of the sea. The cabin is equipped with a private bathroom with shower, sink and toilet.

### Foredeck:

- The Cocos has a spacious lounge on the foredeck with a large sun roof, this is a perfect place to enjoy the surroundings. On the roof of the Cocos there is another sun bed for 2 people.

### Mast and boom:

- The Cocos has a unique black coated mast and a carbon Canoe boom. The boom makes it very easy to lower the mainsail and is much more durable than a lazy bag.





# SPECIFICATIONS

## Technical equipment:

- The Cocos is very well equipped, which makes the comfort on board great and makes it possible to be independent of harbour facilities for a longer period of time. For example, she is equipped with solar panels, a generator, a water maker, a full Cruisair reverse air conditioning, bow thruster, anchor control from the helm, sufficient refrigerators and freezers.
- The helm has electric winches and extensive navigation equipment from B&G, including a plotter, autopilot, wind indicator, radar (doppler) and a carbon steering wheel.

## Sails:

- The sail wardrobe consists of a maindrop battened mainsail, a self-tacking jib, Code-0 and Spinnaker. The sails are all in very good condition.

The Cocos has been sailed with love and punctually maintained, there are no known defects, she is ready to sail for beautiful trips with a new owner. The Cocos was delivered in the Netherlands in October 2019, she is sold by the first owner. As sales manager for Lagoon in the Netherlands, I was involved in the delivery of this Lagoon and I am familiar with its use from delivery to the present.

Do you have any questions or are you interested in this beautiful Lagoon catamaran? Please feel free to contact us or make an appointment for a viewing in Genoa, Italy.





# SPECIFICATIONS

## **Interior wood:**

- Apli walnut with Asburgo floors

## **Equipment:**

- Comfort equipment 4 cabins

## List equipment:

- Fusion MS-RA70 + 4 loudspeakers in salon + 2 loudspeakers in cockpit & helm
- Electrical circuit, ac monitoring, 1 battery charger 220v/12v in aft beam
- Windlass remote control with chain counter at helm station
- Deck courtesy lights in cockpit and transom
- navigation pack B&G 2019
- Gel batteries 1260 Amp
- Deck wash pump sea water/fresh water
- Helm station gate
- Fresh water dock inlet
- Storage units in port and starboard cockpit furniture's

## **Upholstery:**

- Shark brown (salon & settees)
- Pleated blinds in the salon
- Pleated blinds in the cabins

## **Sails rigging and hardware:**

- Pack VGM hydranet
- Code-0 rig, pole & furler
- Asymmetrical spinnaker (250 sqm) with sock
- Carbon canoe boom with LED light, cover graphite and black painted aluminium mast

## **Exterior upholstery:**

- composite bimini at helm station with bimini sides and windscreen graphite
- kit of covers graphite (steering wheel, cockpit table)
- Sunloungers on roof with adjustable backrest- dark grey
- Aft cockpit cushions-dark grey
- Forward cockpit cushions-dark grey
- Cockpit sides & aft sun canvas + sides around aft cockpit & windows + curtains-graphite



# SPECIFICATIONS

## **Deck gear:**

- Folding gangplank
- Boarding ladder with lifeline opening
- Electrical winches in lieu of standard
- Black carbon steering wheel
- forward & aft cockpit transom in teak
- 4 underwater spotlights
- extra for XL tenderlift hydraulic platform with remote
- Teak cockpit table

## **Engines:**

- 2 x 80 hp Yanmar 4JH80
- pair of 3 blades folding propellers for Yanmar 4JH80
- Electric bow thruster 24v 140gfk + batteries + charger
- Electrical circuit:
- Onan genset 17,5 Kva 1500 rpm 220V/50Hz + cocoon + monitoring
- inverter 12v/220v-3000va
- additional charger 100 Amp
- USB sockets in the cabins

## **Water circuit:**

- Water purifier in the galley
- Watermaker 280L/H Sea recovery automatic 220V
- Electrical toilets fresh water

## **Interior equipment**

- Reverse cycle centralized chilled water air-conditioning 60000BTU 220v
- Additional fridge & freezer in starboard passage way
- Washer/dryer 220v
- Under the bed slats in all cabins
- Fans in the salon and cabins

## **Hifi & Electronics:**

- Zeus 3 16" Display at the helm Zeus glass helm 16" display at the nav station
- Radar Doppler
- Sounder forward scan
- Autopilot remote B&G
- VHF B&G transceiver with antenna coupling
- Pepwave max wifi / 4G repeater

## **Dingy:**

- Dingy set Highfield Ocean master de luxe grey with Honda engine BF50 HP

# SPECIFICATIONS

Layout:

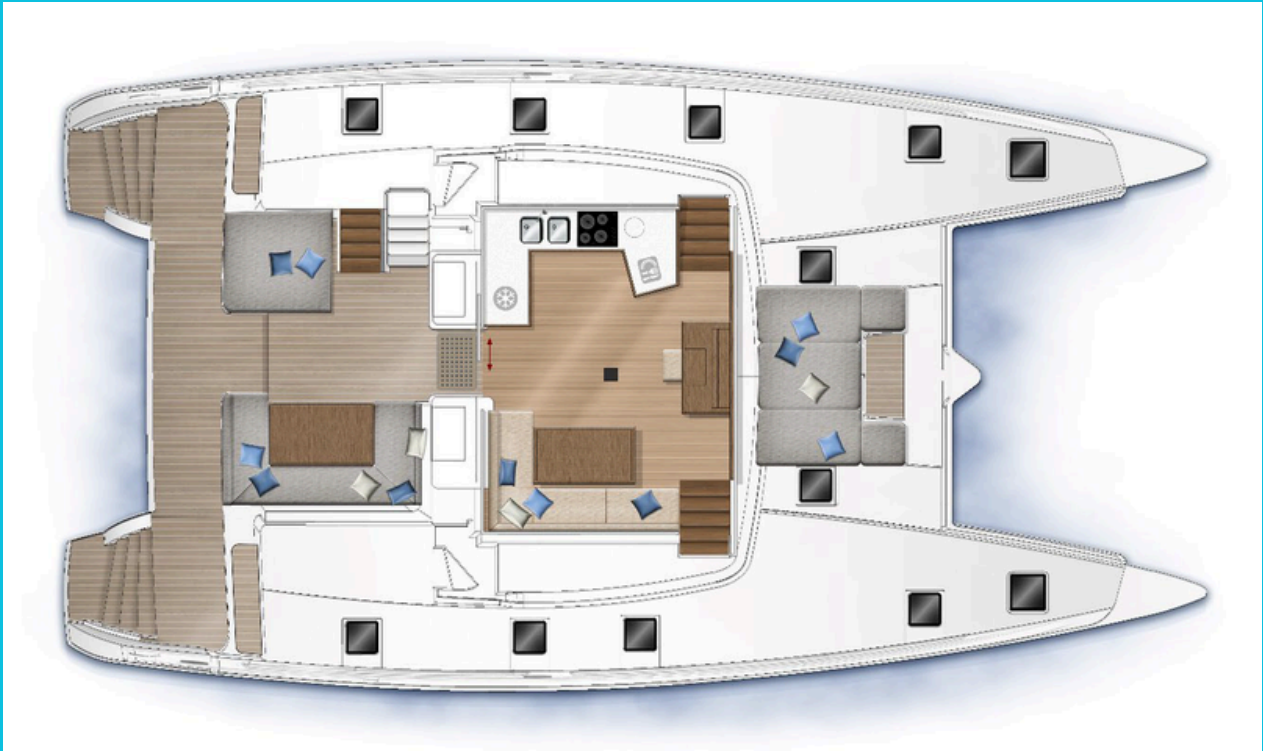

# IMPRESSIONS





# IMPRESSIONS

