



CAPRICE

77 ft Norlin cutter sloop 1988



A SEMI SUPER SAIL
YACHT

www.nautilus-yacht.com
+31 649863471



INFORMATION

Price: €495,000 VAT paid
Location: Teulada, Sardinia
Year: 1988
LOA: 76' 7" / 23.35m
LWL: 68' / 20.72m
Beam: 18' 4" / 5.60m
Draft: 8' 10" / 2.70m
Displacement: 64,000kg / 141,095lb
Hull: polyester
Engines: 2 x Yanmar 4JH110 ZF25 110pk
yard: Brödern Jacobson, Sweden / Orust
Custom Yachts AB
Architect: Peter Norlin
Accommodations: 10 berths in 5 cabins
Refit: 2020



DISCRIPTION

Sailing yacht "Caprice" is a 77 ft custom build Norlin Cutter sloop yacht with superyacht allure. Built at the Swedish shipyard Brödern Jacobson in 1988. A very spacious and robustly built yacht designed by nautical architect Peter Norlin. The beautiful line of the Caprice exudes seaworthiness. This is really a yacht to make long journeys with. With a spacious salon with lots of light and views through the deck saloon windows, a very spacious galley that is fully equipped and 5 cabins with 10 berths including a very spacious owner's cabin make the stay on board the Caprice very pleasant. The Mahony wooden interior gives a classic and chic ambiance, the many details and leather upholstery ensure a very neat appearance.

The owner's cabin is very spacious and equipped with its own wet cell, a spacious sitting area and a library with work space.

Above deck there is a mid-cockpit with a spacious round seat with lots of shelter and a Bimini. The helm is double and offers a perfect overview due to the elevation. With triple forestays equipped with hydraulic furlers, changing and setting up the sails is easy.

The Caprice has had a major refit in 2020 with many major innovations and improvements. Part of the refit was the installation of 2 new Yanmar engines, a complete refit of the teak deck, electrical installations, heating/air conditioning, roof hatches, sails and more. The refit was carried out by the Spanish shipyard Varando Amjomar.

Do you have any questions or are you interested in this beautiful and unique sailing yacht? Please feel free to contact us or make an appointment for a viewing in Sardinia. For an extensive impression, you can watch our video.



SPECIFICATIONS

Construction:

- The Caprice is built with a polyester sandwich construction of the hull.
- The hull consists of 8 watertight compartments.
- A solid polyester deck and superstructure.
- The entire deck is covered with teak wood that was renewed in 2020

Keel:

- Shallow integrally cast fin keel, provided with a screwed cast lead ballast at the bottom.
- Partially balanced rudder hangs from a stainless steel rudder stock and is also supported by
- a short skeg that is integrally cast to the hull.
- Double wheel steering.
- Emergency tiller.

Engines:

- 2 x Yanmar 4JH 110 ZF25 110hp/81kW 2020 with 750 hours
- Aqua drive transmission 2020

Propellers:

- 2x Max Prop 3 bladed propellers

Bow thruster:

- MaxPower 15kW bow thruster

Deck equipment:

Rigging:

- Keel-stepped Reckmann 3-spreader white painted aluminium mast with in-mast furling system and
- hydraulic power pack.
- Reckmann aluminium, white painted boom.
- Standing rigging of stainless steel wire (probably from 2013).
- Rod forestays.
- Running backstays.
- 2 x Furler Selden furling systems for genoa, operated from hydraulic power pack.
- Inner stay with Reckmann hydraulic furling system.
- 2 x Navtec hydraulic backstay adjusters.
- Navtec hydraulic boom downhaul.
- Sailtec hydraulic cockpit control panel for backstay and boom vang.
- White painted aluminium spinnaker pole mounted in stainless steel bracket on mast.



SPECIFICATIONS

Winches:

- Lewmar self-tailing winches:
- 2 x 70 ST – electric primary winches on aft cockpit.
- 4 x 65 ST – mainsheet (3 speed), mainsheet, staysail sheet (2 speed), on side cockpit.
- 2 x 55 ST – running backstays, aft.
- 2 x 40ST – main carriage adjusters, on aft cockpit.
- Mast winches:
- 3 x 55 ST, on mast.
- 1 x 52 ST, on mast.
- 2 x 43 ST, on deck in front of mast.

Sails:

- From Sail Service Poland, new 2020.
- Mainsail in mast, 110m².
- Roller furling genoa, 194m².
- Roller keel, 142m².
- Roller staysail.
- General:
- Stainless steel double railing bow pulpit.
- Tapered stainless steel stanchions, with protection wires.
- Stanchions on port and starboard side form boarding gates.
- Aft cabin roof equipped with the mainsheet rail at the front.
- Spacious aft deck, with a storage compartment.
- Stainless steel "goal post" at the stern with stainless steel davit arms to hold/lift the tender.
- Stainless steel side boarding ladder.
- Alloy and teak passerelle.

Cockpit:

- The cockpit is slightly raised from the main deck. The forward part is protected by a
- high "breakwater" placed on the forward cabin roof and topped by a stainless steel
- sprayhood frame.
- A large fixed bimini extends across the entire cockpit from the "breakwater" to the aft coaming with
- stainless steel frame and lighting.
- Front extensions of the cabin side berths protect the two helm stations: each placed in a forward corner, either side of the main accommodation hatch.



SPECIFICATIONS

- Steering wheels are mounted on square pedestals against the aft cabin bulkhead and
- provided with compass mirrors. Curved, teak-slatted, stainless steel helmsman's chairs -
- adjustable for fore and aft position, and easily removable.
- Next to the starboard wheel is a Garmin autopilot control box and two single lever
- engine controls, plus control panels for Yanmar engines, MaxPower bow thruster, external lights
- and windlass controls.
- On the port side of the cockpit, next to the wheel, are push-button controls for furling
- mainsail; genoa; yankee and staysail.
- Plastimo compass at each helm.
- Garmin GPS plotter for the starboard wheel in a stainless steel forebox.
- Amidships, and above the sliding hatch cover, is a bank of Garmin instrument repeaters and VHF.
- Fusion cockpit speakers.
- U-shaped aft section of the cockpit with comfortable seating.
- Varnished teak cockpit table, height adjustable, foldable.

Electrical system:

- 24V DC and 220V AC systems.
- Victron isolation transformer.
- Victron Galvanic isolator VD1-32A.
- Victron battery insulator.
- Victron "colour control" system with panel by nav station.
- Batteries: Service and start batteries 2020. Divine AGM 12V batteries for service.
- 2 x Exide Energy batteries starter batteries Chargers: 220V/24V 40A battery charger shore power charger 2017.
- Victron 5kW inverter 2019. Victron Energy blue power charger 12-10.
- Victron Blue smart charger 12V 30A.
- Victron Phoenix smart charger 24V 25A.
- Sterling digital 4 step battery to battery charger.
- 4 x Victron Energy Orion-Tr Smart 12-24-15 isolated DC-DC chargers (input 8-17V. Output 18-30V. Power 360W).
- Victron blue power Quattro charger inverter, 24V – 5000W – 120Amp.
- Blue Solar charge controller MPPT 100-30.



SPECIFICATIONS

Altenators:

- 2x 60 ah dynamo Generator: Sole 19 GSC 9.4kW 2020. .
- Start panel by chart table and in generator room.
- Watermaker: Newport 400 MKII watermaker Bilge pumps: 4x electric bilge pump, galley. engine room, generator room and under the owner's cabin
- Fuel:
- 3500 litres divided over 7 tanks
- Water tanks:
- 700 litres
- 2x waste water tanks of 150 litres
- 2x grey water tanks
- Navigation and communication equipment:
- At the chart table:
- Lenova PC with monitor and keyboard
- Icom IC-M605 VHF
- At the helm:
- 2 x Garmin MFD.
- 1 x Garmin wind direction.
- Garmin plotter GPS Map.
- Garmin autopilot.
- 2 x Plastimo compass.
- Icom M600 VHF.

Galley:

- ENO 3 burner gas stove with gas oven 2020.
- Vestel dishwasher.
- Bosch washing machine.
- Isotherm 24V refrigerator, front opening
- Vitrifrigo wine cooler in saloon.
- 24V Frigomar freezer.
- 2 x 24V Frigomar cool boxes

Heating and Air Conditioning:

- Frigomar air conditioning unit with reverse heating cycle, ducting air to upper saloon / aft
- cabin and guest cabins 2020.
- Hot water radiator heating (aft cabin, upper saloon, galley), plus 6 x passive heaters (3 forward cabins).
- Fan fans throughout the yacht.

SPECIFICATIONS

Entertainment:

Fusion music system with speakers in cockpit and saloon

Lighting:

- 24 volt partial LED
- Navigation lights
- Underwater lighting

Accommodation:

- 5 cabins with 10 berths
- Woodwork Mahogany
- Green leather upholstery in both saloons.
- Exposed upper sides in all sleeping cabins are covered with varnished mahogany slats

Layout:

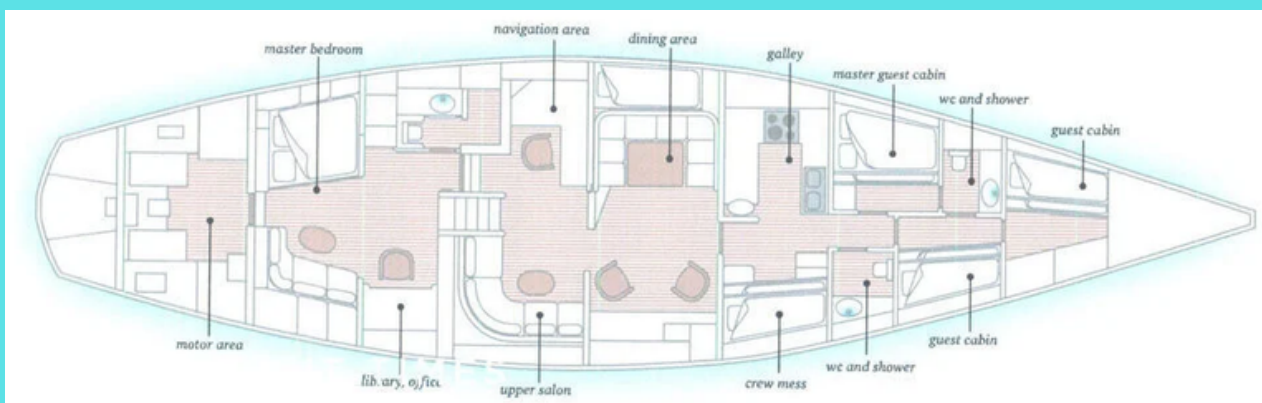

SPECIFICATIONS

REFIT 2020:

- 2 x new Yanmar engines installed by Yanmar agent in Cartagena.
- 1 x new Sole generator.
- New sails.
- Teak deck refitted.
- New navigation equipment.
- New outboard engine for tender.
- New deck hatches.
- Winches serviced.
- 2 x Quick anchor windlass + remote control at rudder (one new and one refitted).
- 2 x Furlex headsail furling systems (refitted).
- New electrical panel and wiring.
- New Frigomar refrigerator system and compressor + freezer.
- New Eno gas stove.
- Fire detection system.
- All thru-hull fittings replaced.
- Frigomar heating and air conditioning.
- Chargers and inverter.
- Green leather upholstery in saloons.



IMPRESSIONS

